



www.takemethere.cc.nih.gov



1st Floor

The Mark O. Hatfield Clinical Research Center

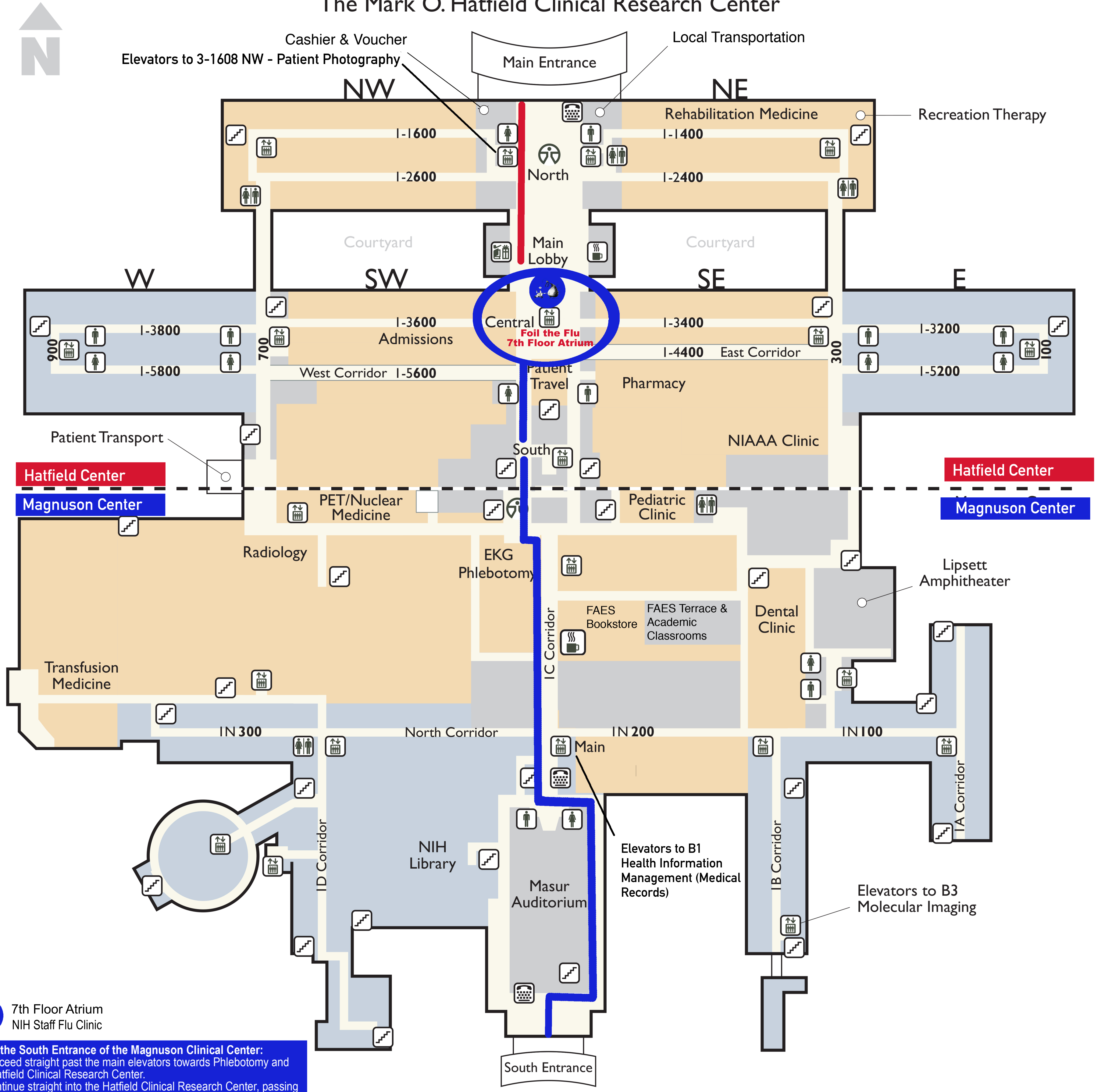

7th Floor Atrium
NIH Staff Flu Clinic

From the South Entrance of the Magnuson Clinical Center:
 1. Proceed straight past the main elevators towards Phlebotomy and the Hatfield Clinical Research Center.
 2. Continue straight into the Hatfield Clinical Research Center, passing Admissions (on your left).
 3. Across from Admissions, take the central elevators to the 7th floor atrium area.

From the Main (North) Entrance
 1. Proceed past the Hospitality desk through the atrium area to the central elevators (adjacent to Admissions/Patient Travel).
 2. Take the central elevators to the 7th floor atrium area.

The Warren Grant Magnuson Clinical Center

- Restrooms
 - Stairs
 - Elevators
 - Hospitality
 - TTY Phone
 - Coffee Shop
 - Gift Shop
- Hatfield Room ID**

Floor
Corridor
Room

I-5600 SW

Patient Areas

Research/Lab Areas